

Mit Mausclick gelangen Sie zum [Blaetterkatalog]

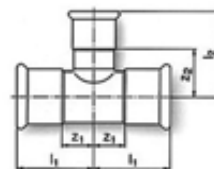

S4

Mapress T-Stück reduziert

| SAP-Nr. | Artikel-Nr. | DN | d1/3 | d2 | L1 | L2 | z1 | z2 | VE | CHF |
|---------|-------------|--------|------|------|-----|-----|----|----|-------|--------|
| SPAETER | Lieferanten | | mm | mm | mm | mm | mm | mm | Stück | Stk. |
| 145487 | 31246 | 100/32 | 108 | 35 | 155 | 108 | 80 | 82 | 2 | 199.00 |
| 129128 | 31247 | 100/40 | 108 | 42 | 155 | 110 | 80 | 80 | 2 | 199.00 |
| 145488 | 31248 | 100/50 | 108 | 54 | 155 | 113 | 80 | 78 | 2 | 199.00 |
| 145489 | 31249 | 100/65 | 108 | 76.4 | 155 | 124 | 80 | 71 | 2 | 199.00 |
| 145490 | 31250 | 100/80 | 108 | 88.9 | 155 | 135 | 80 | 75 | 2 | 199.00 |

Werkstoffe:

Cr-Ni-Mo-Stahl 1.4401 (DIN EN 10088)

Mapress Kupplung

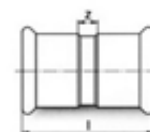

| SAP-Nr. | Artikel-Nr. | DN | D | L | z | VE | CHF |
|---------|-------------|-----|------|-----|----|-------|-------|
| SPAETER | Lieferanten | | mm | mm | mm | Stück | Stk. |
| 145491 | 32009 | 65 | 76.1 | 141 | 35 | 4 | 66.00 |
| 145492 | 32010 | 80 | 88.9 | 162 | 42 | 4 | 75.00 |
| 145493 | 32011 | 100 | 108 | 194 | 44 | 2 | 97.00 |

Werkstoffe:

Cr-Ni-Mo-Stahl 1.4401 (DIN EN 10088)

Mapress Langkupplung

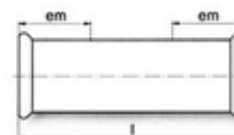

| SAP-Nr. | Artikel-Nr. | DN | D | L | em | VE | CHF |
|---------|-------------|-----|------|-----|----|-------|--------|
| SPAETER | Lieferanten | | mm | mm | mm | Stück | Stk. |
| 145494 | 32109 | 65 | 76.1 | 230 | 60 | 2 | 98.00 |
| 145495 | 32110 | 80 | 88.9 | 260 | 70 | 2 | 111.00 |
| 145496 | 32111 | 100 | 108 | 310 | 80 | 2 | 134.00 |

Werkstoffe:

Cr-Ni-Mo-Stahl 1.4401 (DIN EN 10088)